

# robustdetails®



# HBF Technical Conference 2014 - Robust Details



# What does Robust Details Limited ACTUALLY do?...



192.com  
People, Businesses & Places

Who / What  
All e.g. John Smith or Tesco

Where  
Knowlhill, Milton Keynes, B Search

Background Reports  
Protect yourself with our detailed report

192.com People Businesses Places Help Sign In / Register

Home » Businesses A-Z » Milton Keynes businesses » Mot Testing in Milton Keynes » Robust Details Ltd

Robust Details Ltd - Mot Testing in MK5 8NB  
★★★★★ (1 Review) Add review

Address:  
The Fusion Building  
Davy Avenue  
Knowlhill  
Milton Keynes  
Buckinghamshire  
MK5 8NB

0870 240 8210  
Fax: 0870 240 8203  
Save to Mobile  
Save to Addressbook

Get Credit Report Monitor company report Free!

Classification:  
Classification: Mot Testing Stations

Find out more about:  
Knowlhill Milton Keynes MK5 8NB - who lives there, property prices and lifestyle data.

Source of Information: Dun and Bradstreet

Ads by Google

TCH Derby MOT Testing  
www.tch.co.uk/mot-test MOT Testing Service While You Wait.

Souls Coaches  
www.souls-coaches.co.uk For all your Coach Hire in

Customer Reviews

1 customer would recommend this business to a friend

How to write a review?

Average customer review  
★★★★★  
(1 review)

Add Review

★★★★★ dave baker - 20 March 2014 15:03

Report abuse

Took my car to be MOT'd but found instead that Robust Details provides a fantastic alternative to pre-completion sound testing for new homes. Imagine my surprise! The guys there were very helpful and their levels of service are great. Apparently, there's loads of robust detail solutions for full-fill party walls, enabling builders to meet Part L and Part E. They also pointed out that my wiper blades needed replacing. Highly recommended.

Show less

Cookie Policy | Terms | Privacy | International | Our Blog | People A-Z | Businesses A-Z | About Us | © 192.com Ltd

Claim / Edit

Map navigation controls: N, zoom in/out, street view, etc.

Bird's eye

Aerial map view showing the location of Robust Details Ltd (marked with a yellow pin) on Davy Avenue, Knowlhill, Milton Keynes. The map includes street names like Avenue and Way, and a scale bar.

Expand map view

Argos

Save 25%  
Power Ranger Scooter



was £19.99  
now £14.99

Ends 25/03/2014

Shop now

# What does Robust Details Limited ACTUALLY do?...



## Robust Details Ltd - Mot Testing in MK5 8NB

★★★★★ (1 Review) [Add review](#)

### Address:

The Fusion Building  
Davy Avenue  
Knowlhill  
Milton Keynes  
Buckinghamshire  
MK5 8NB

 0870 240 8210

Fax: 0870 240 8203

 [Save to Mobile](#)

 [Save to Addressbook](#)

[Get Credit Report](#)

[Monitor company report](#) **Free!**

### Classification:

Classification: Mot Testing Stations



# What does Robust Details Limited ACTUALLY do?...

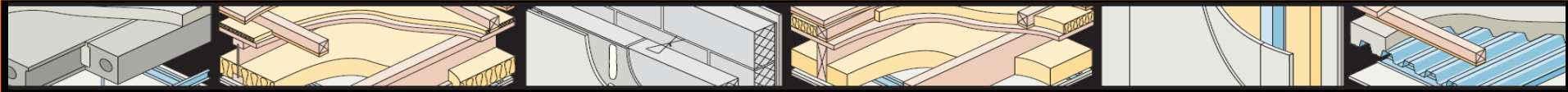

★★★★★ ~~\*\*\*\*baker~~ - 20 March 2014 15:03

Took my car to be MoT'd but found instead that Robust Details provides a fantastic alternative to pre-completion sound testing for new homes. Imagine my surprise! The guys there were very helpful and their levels of service are great. Apparently, there's loads of robust detail solutions for full-fill party walls, enabling builders to meet Part L and Part E. They also pointed out that my wiper blades needed replacing. Highly recommended. [Show less](#)

**Report abuse**

# The Scheme



To use the **robust**details® option, the 'Person carrying out the work' **must**:

- **Select** appropriate **Robust Details** from the **Handbook\***, and
- **Design** in accordance with the relevant Robust Detail specification(s)

(\*Handbook available *FREE* on-line at [www.robustdetails.com](http://www.robustdetails.com) )

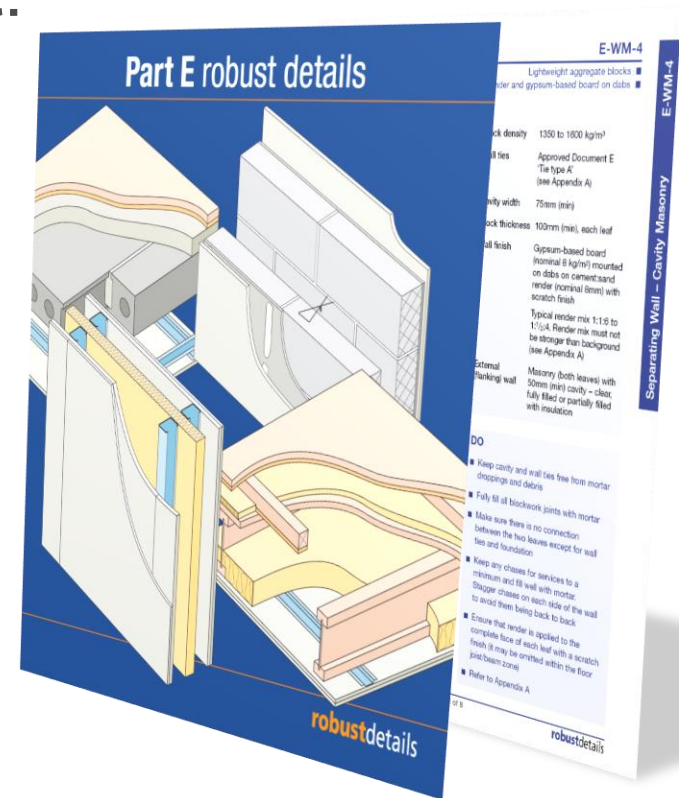

# The Scheme

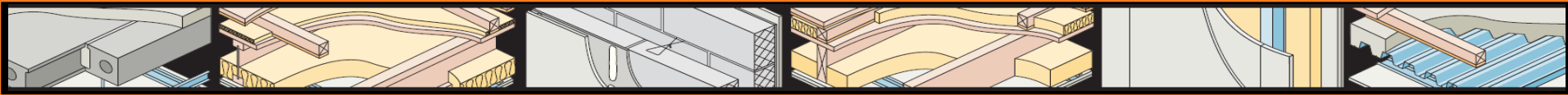

To use the **robustdetails**® option, the ‘Person carrying out the work’ **must**:

- **Register** each plot with Robust Details Limited [*now on-line at [www.robustdetails.com](http://www.robustdetails.com)* ]
- **Give** registration document to the **BCB** [before work starts]
- **Build** in accordance with the relevant **Robust Detail specification**
- **Satisfy** the **BCB** that the relevant requirements have been met
- **Agree to be subject to robustdetails**® scheme **surveillance** (if selected)

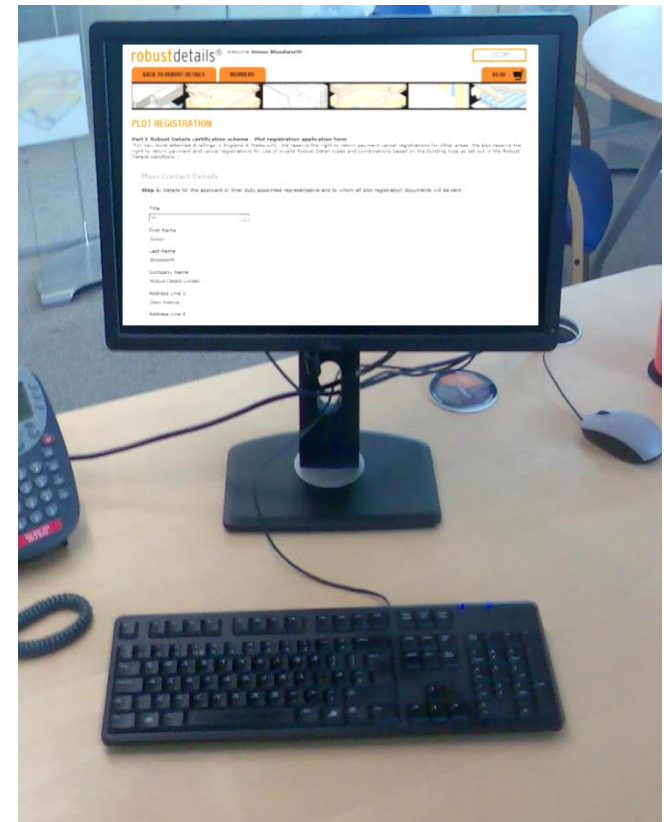

# HBF Technical Conference 2014 - Robust Details

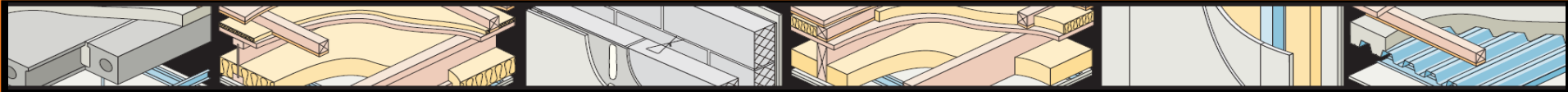

***Surveillance:***

*RDL Inspection and Testing*



# Surveillance findings



**12,000+ tests** have been undertaken

Of these:

- 3.1% did not achieve the performance expected of a Robust Detail;
- 98.3% met the Building Regulations requirements

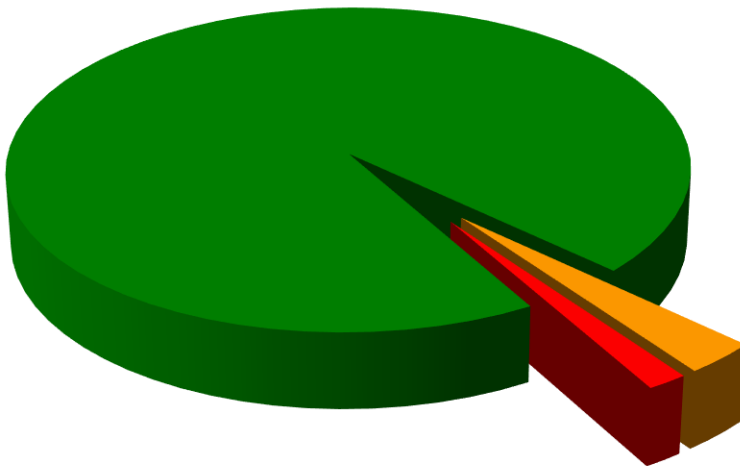

	Airborne $D_{nT,w} + C_{tr}$	Impact $L'_{nT,w}$
Building Regulations	45	62
Robust Detail	47	60

# Common Problems...

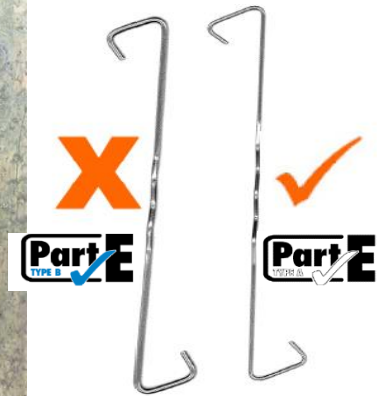
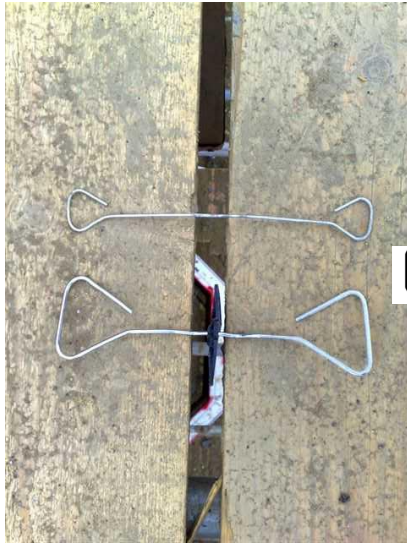
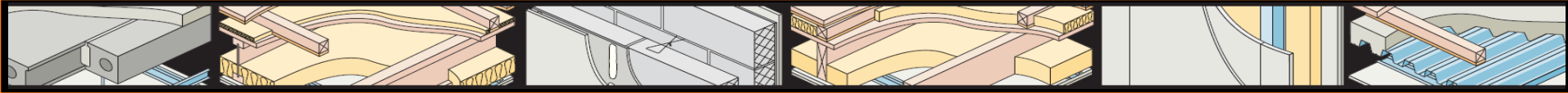

**Wrong wall ties**



**Bridged cavities**

**Bridged resilient layers**

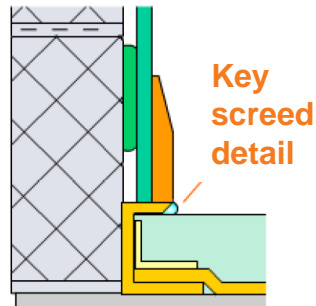

# HBF Technical Conference 2014 - Robust Details





# HBF Technical Conference 2014 - Robust Details

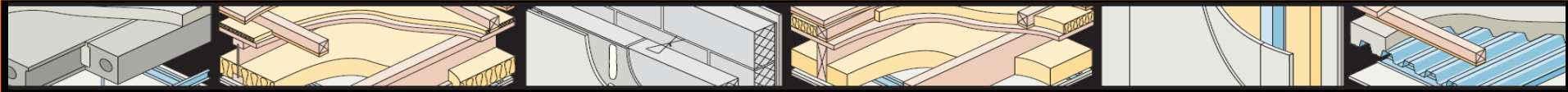

**robust**details®

What Next?



# Beyond Part E

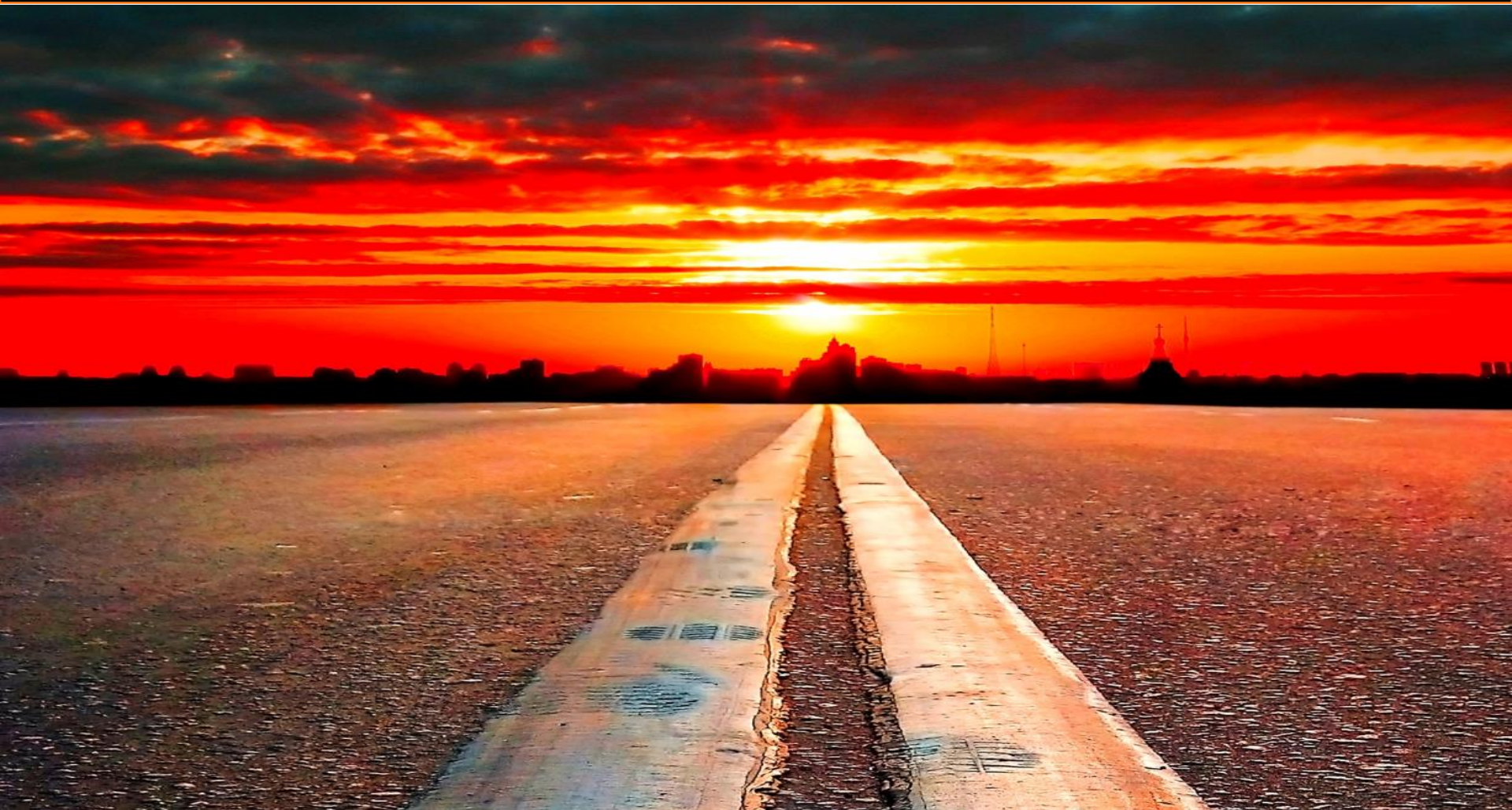

# The Scheme



Its all about context...



A bit like car production:

- a prototype is developed
- testing is undertaken

If successful, the same design can be repeated without the need for further testing

# Ventilation

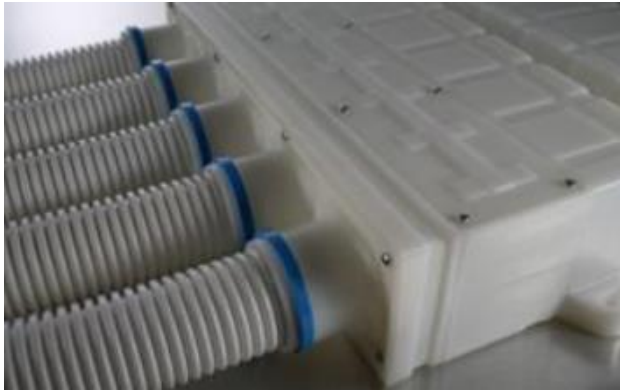

- MEV and MVHR becoming more common
- 25,000 in dwellings, 15,000 in non-domestic each year
- Issues with design, installation, commissioning
- Looking at a pattern book approach
  - Robust technical systems
  - Noise, usability also factors for owners
- Piloting 2014/15 with selected partners



# Design versus Actual



## Some homes don't perform as designed

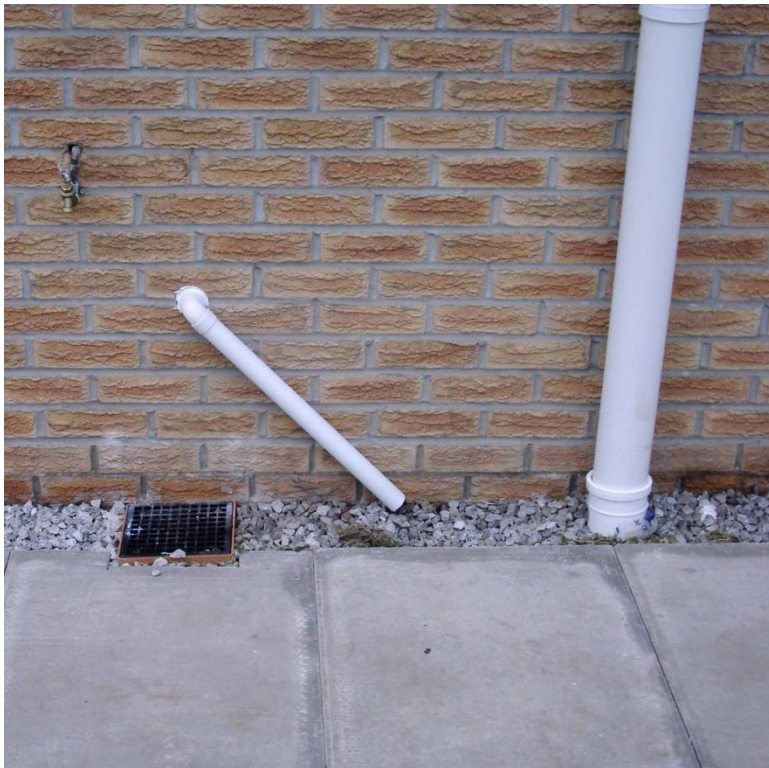

- Design it right, build it right, get the data right
- SAP as a model of reality is OK-ish
- Issues seem to be linking processes
- Could we standardise process and product a bit
- Possible role for Robust Details



# Thermal bridging



## constructive **DETAILS**

- Becoming critical in Part L 2013
- Multiple sources of guidance
  - Government
  - NHBC and Industry
  - Constructive Details
- Buildable, checkable, robust, sustainable?
- Integration with BIM



# BIM

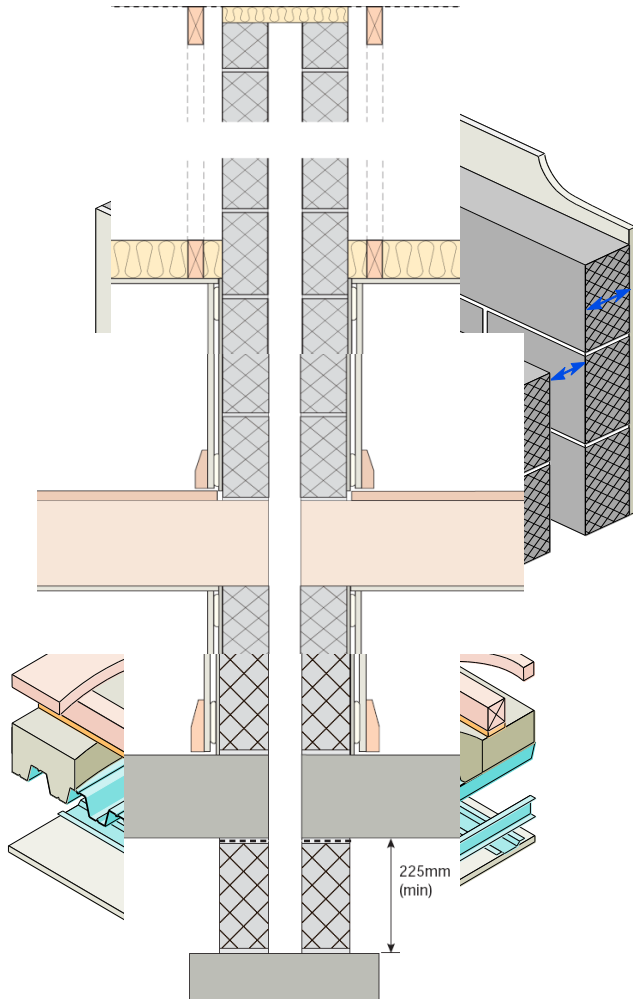

- The scary bit – it will transform construction
- Comforting bit – more on processes than stuff
- Standardised, structured data is key
- Pretty 3D drawings are secondary
- Working on it so we are ready, when necessary, to support industry

# Allowable Solutions

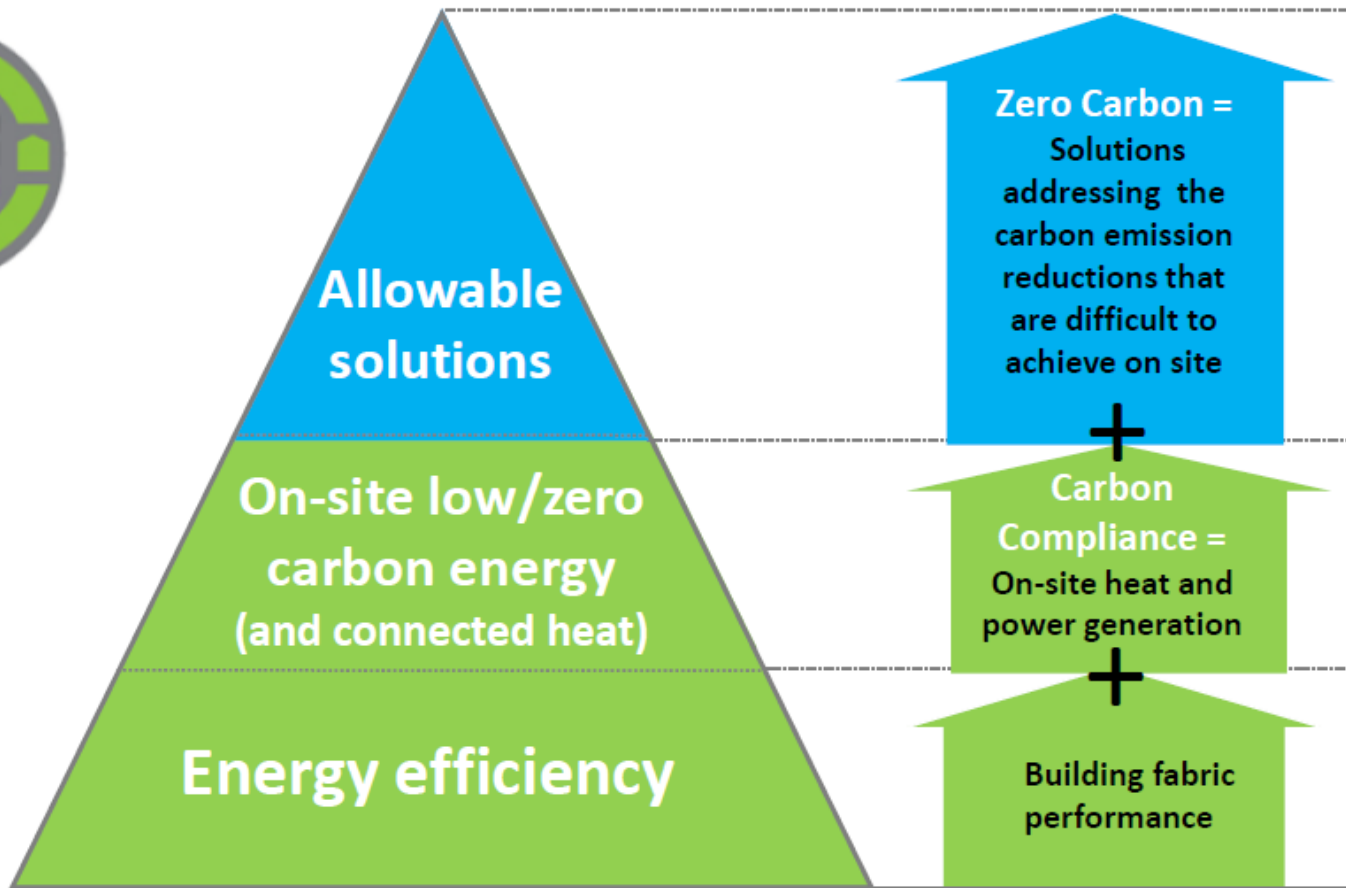

# Allowable Solutions



## Allowable solutions

- We are not interested in what its spent on
- Are interested in making it easy to use
- Integrate with SAP, Part L and building control
- Demo developed of a system
- Maximise choice, minimise administration costs
- Trialling soon with ZCH and others



# HBF Technical Conference 2014 - Robust Details



# Conclusions



## **Defra report NANR 314:**

An investigation into the effect of historic noise policy interventions



## **Building Regulations, Part E:**

- “The net effect of the policy over the period 2003 – 2010, assessed in terms of preventing 'failures', was estimated to have been about 198,000 attached houses and 111,000 purpose-built flats”.

# Conclusions



## NHBC Foundation Report NF56:

**Sound Progress:** A review of homeowner feedback on noise in new homes

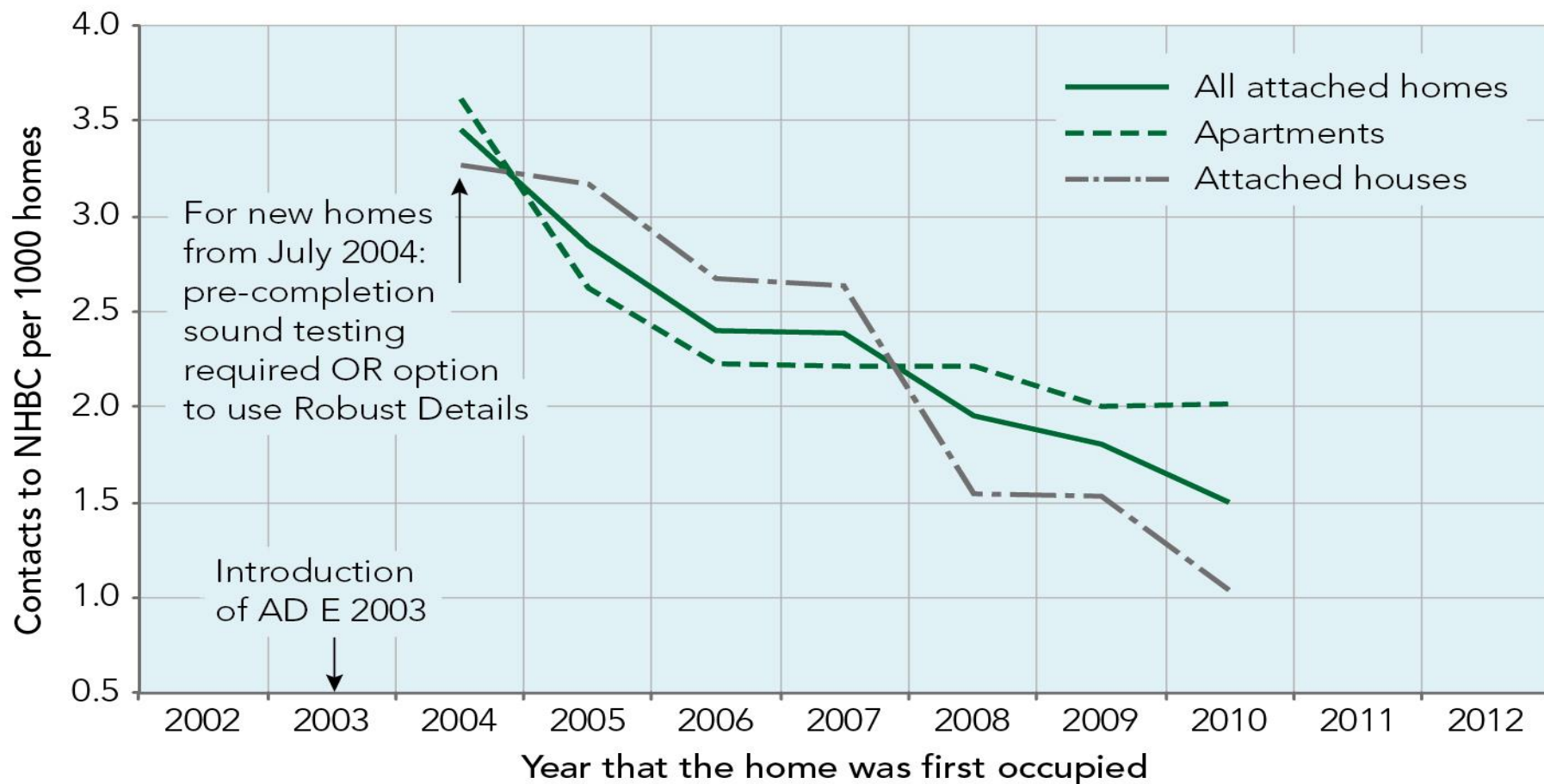

# Conclusions



## NHBC Foundation Report NF56:

**Sound Progress:** A review of homeowner feedback on noise in new homes



### Attached Homes:

- “From 2004, attached homes built in successive years generated progressively fewer homeowner contacts related to noise problems...”
- “...this was largely due to fewer concerns over transmission of noise from adjoining homes.”



# Conclusions



## Report NF56 Sound Progress



### Attached Homes (contd.):

- “The start of the downward trend coincides with the new regulatory guidance in AD E 2003 and the associated launch of the Robust Details scheme in 2004.”

### Detached Homes:

- “From 2004, owners of detached homes were more likely to contact NHBC in relation to noise issues than those living in attached homes.”

# HBF Technical Conference 2014 - Robust Details



**Thank You**